



PATENTS PENDING

Expand Access Enhance Care In Just 60 Days

Unlock New Potential with Akumin
AXIS Expandable Patient Solutions™



Achieve More with Akumin

Advance your oncology services with Akumin's proven expertise and innovative care models. From joint venture fixed-site partnerships and managed services, to interim mobile offerings and our pioneering relocatable and expandable Akumin AXIS™ suites, we provide the flexibility and scale to help hospitals meet rising patient demand and achieve long-term success.

With deep industry experience and a commitment to excellence, Akumin helps partners reach the highest standards of quality, efficiency, and profitability. Trusted by more than **1,000 hospitals**, including **23 of the top 30 healthcare systems**, we are a recognized leader in the field.

Partner with Akumin to:

- ✓ Deliver Exceptional Care
- ✓ Optimize Operations
- ✓ Grow Capacity



Accessible Oncology Services, Delivered On-Site

Akumin AXIS Expandable Patient Solutions™ are the first relocatable and expandable outpatient centers designed to meet today's critical radiology and oncology needs. Akumin AXIS helps hospitals deliver uninterrupted patient care, preserve referrals, and sustain revenue during equipment upgrades or when evaluating demand before committing to permanent facilities.

As part of Akumin's oncology services portfolio, Akumin AXIS LINAC offers rapid, flexible deployment of advanced technologies and clinical expertise. The result is seamless patient experiences and efficient expansion of cancer care capabilities.



Unlock New Potential with Akumin AXIS Expandable Patient Solutions™



Rapidly Expand Patient Access

Serve more patients without the delays of traditional construction.



Relocatable Design

Temporary placement keeps radiation therapy running smoothly during new equipment installation or upgrades.



Cost Efficiency

Reduce costs by eliminating the need for expensive brick-and-mortar investments.



Seamless Installation

Linear accelerator equipment arrives pre-installed, enabling a quick go-live.



Enhanced Patient & Staff Experience

Unit features a contemporary design with high ceilings and natural light.

Designed for Comfort and Efficiency

The Akumin AXIS™ suites deliver a spacious, modern care environment that goes beyond the limitations of traditional mobile units. While trailers have helped extend access to imaging, very few are capable of supporting advanced oncology treatments.

Akumin AXIS offers direct walk-in entry, wide corridors, and thoughtfully designed interiors that reduce feelings of claustrophobia while promoting comfort and confidence.

Patients benefit from a calmer, more supportive setting, while staff gain the space and ergonomics needed to work efficiently and collaborate effectively. Akumin AXIS gives hospitals a modern alternative to bring leading-edge cancer care to more patients.

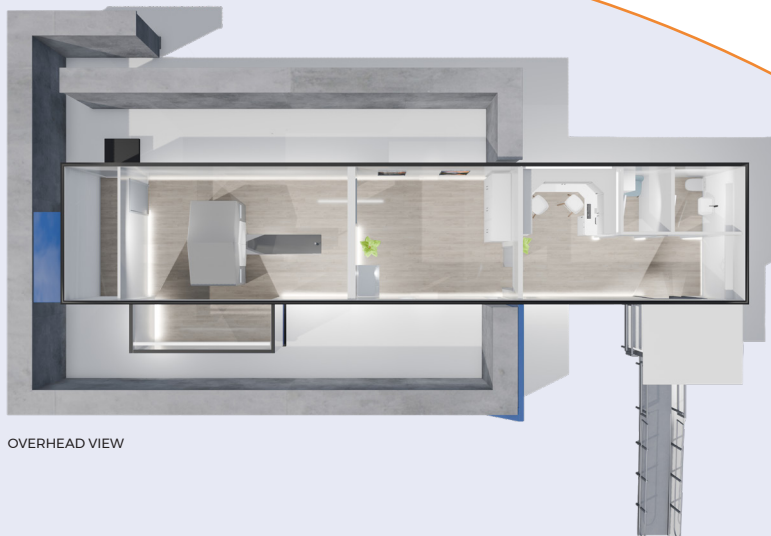

OVERHEAD VIEW



Precise and Efficient Radiation Therapy Treatment

Featuring the LINAC-configured Varian Halcyon™, an FDA-approved linear accelerator, Akumin AXIS LINAC delivers safe, fast, and precise radiation therapy with rapid deployment. Hospitals can maintain treatment schedules and ensure patients stay on track with their care, all without the costly delays of traditional brick-and-mortar construction.

Key Points About the Halcyon System

- ✓ **Faster treatment times** - Compared to standard radiation machines, the Halcyon can deliver treatments much quicker due to its rapid gantry rotation and advanced technology.
- ✓ **Image-guided precision** - Utilizes cone-beam CT imaging to precisely target tumors while minimizing damage to surrounding healthy tissue.
- ✓ **Patient comfort features** - Designed with features like ambient lighting, reduced noise levels, and a comfortable treatment couch to enhance patient experience.
- ✓ **Advanced techniques** - Supports various radiation therapy techniques including volumetric modulated arc therapy (VMAT) and intensity-modulated radiation therapy (IMRT).



Ready to Learn More?

Enhance your oncology services with Akumin's innovative solutions.

Scan the QR code below to view our range of oncology services or email our sales team at solutions@akumin.com



PATENTS PENDING

Discover Akumin AXIS in Action

Learn more about the world's first expandable, relocatable patient solution and see how it integrates seamlessly into healthcare operations.

Watch videos and explore Akumin AXIS — [Akumin.com/axis](https://akumin.com/axis)

Akumin, Bringing Imaging Closer®

